

GRIGRI

CE 0082 UIAA

EN 15151-1 type 6: 2012

Assisted-braking belay device
 Appareil d'assurage à freinage assisté

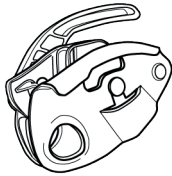

WARNING / ATTENTION

Activities involving the use of this equipment are inherently dangerous. You are responsible for your own actions and decisions.

Before using this equipment, you must:
 - Read and understand all Instructions for Use.
 - Get specific training in its proper use.
 - Become acquainted with its capabilities and limitations.
 - Understand and accept the risks involved.



FAILURE TO HEED ANY OF THESE WARNINGS MAY RESULT IN SEVERE INJURY OR DEATH.

Les activités impliquant l'utilisation de cet équipement sont par nature dangereuses. Vous êtes responsable de vos actes, de vos décisions et de votre sécurité.

Avant d'utiliser cet équipement, vous devez :
 - Lire et comprendre toutes les instructions d'utilisation.
 - Vous former spécifiquement à l'utilisation de cet équipement.
 - Vous familiariser avec votre équipement, apprendre à connaître ses performances et ses limites.
 - Comprendre et accepter les risques induits.



LE NON-RESPECT D'UN SEUL DE CES AVERTISSEMENTS PEUT ÊTRE LA CAUSE DE BLESSURES GRAVES OU MORTELLES.

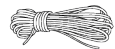

Rope (core + sheath) dynamic (EN 892)
 Corde (âme + gaine) dynamique (EN 892)

$8.5 \leq \varnothing \leq 11 \text{ mm}$



1. Field of application (text part) Champ d'application (partie texte)

2. Nomenclature

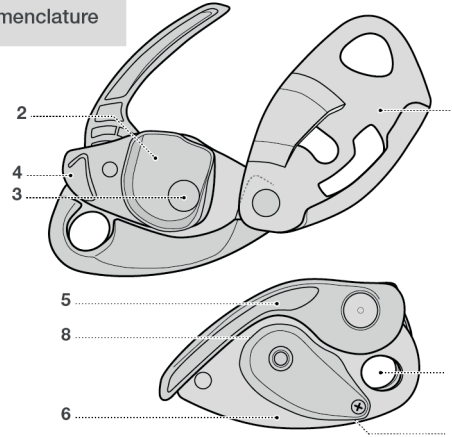

3. Inspection, points to verify Contrôle, points à vérifier



PPE checking
 Vérification EPI
 PETZL.COM



4. Compatibility (text part) Compatibilité (partie texte)



Traceability and markings Traçabilité et marquage

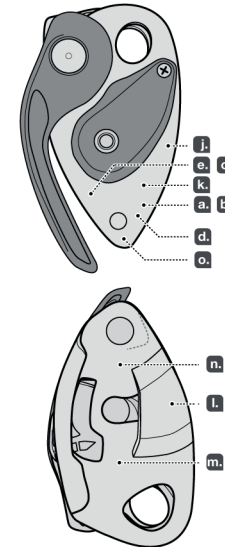

PETZL
 F-38920 Crolles
 Cidex 105A
 PETZL.COM
 ISO 9001
 © Petzl



5. Function principle and test
Principe et test de fonctionnement

Function principle
Principe de fonctionnement

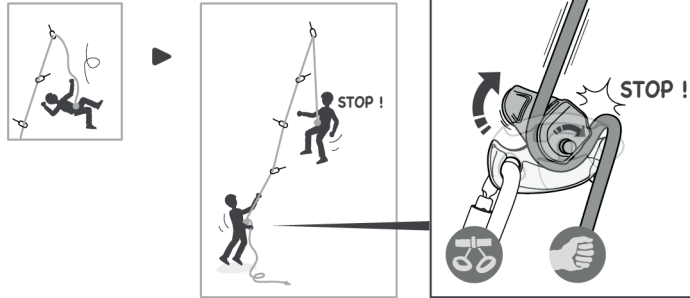

Function test
Test de fonctionnement

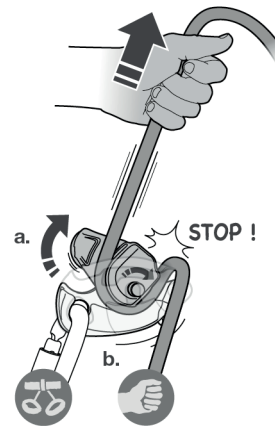

6. GRIGRI + installation
Installation du GRIGRI+

1.

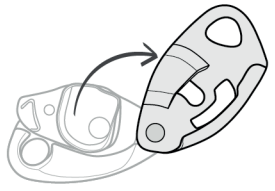

2.

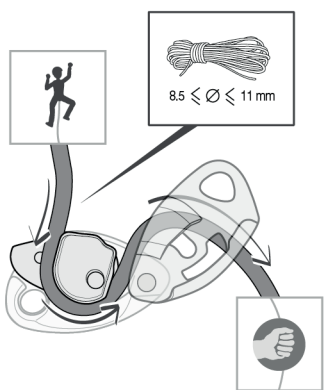

3.

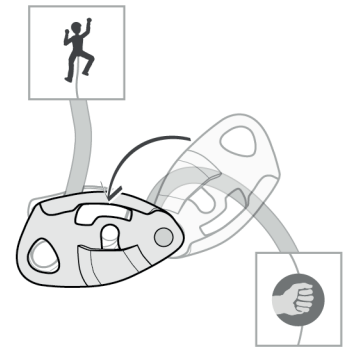

4.

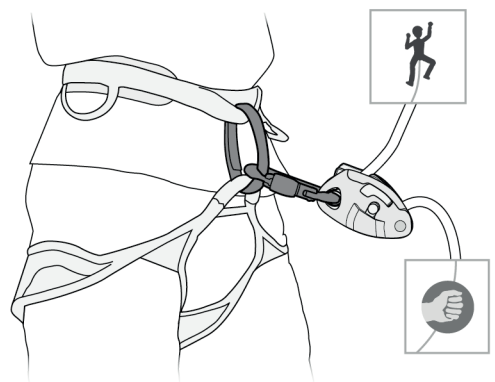

5. PARTNER CHECK

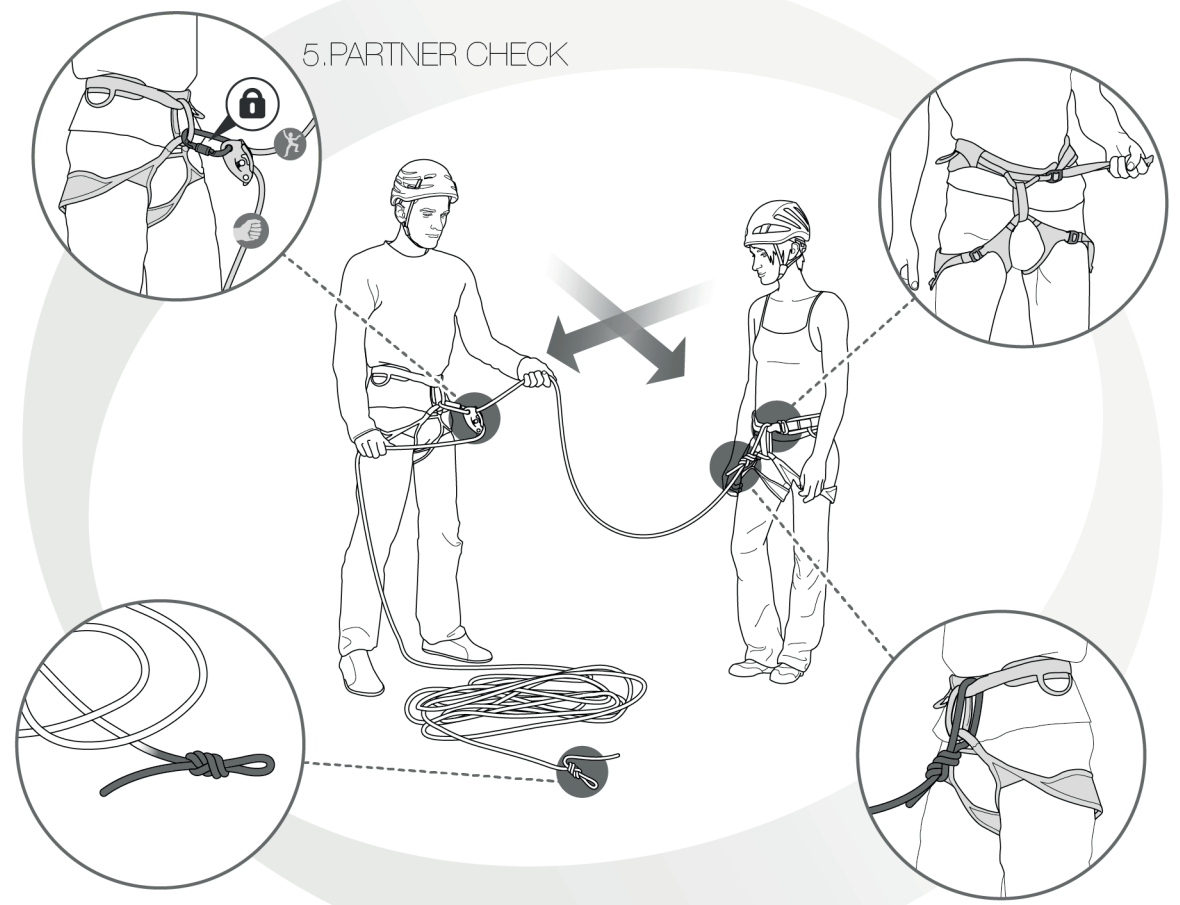

7 Belaying techniques
Techniques d'assurage

7A. Primary belaying position
Position principale d'assurage

Be attentive
Être attentif

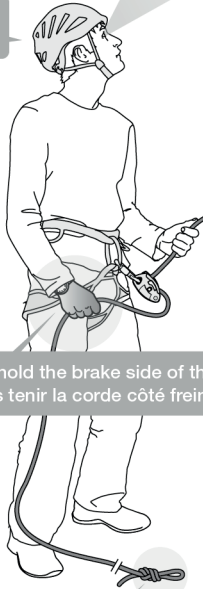

Always hold the brake side of the rope
Toujours tenir la corde côté freinage

Tie a knot in the bottom end of the rope
Faire un nœud en bout de corde



7B. Giving slack
Donnez du mou

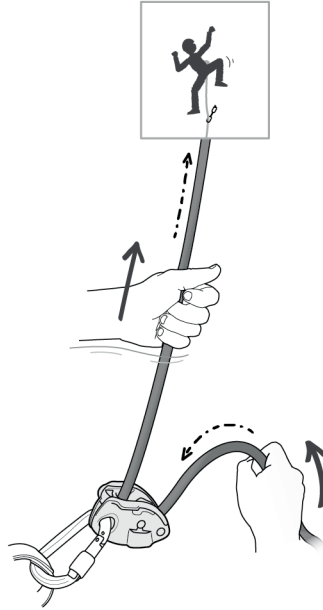

7C. Giving slack quickly when the leader is clipping
Donnez du mou rapidement lorsque le leader mousquetonne

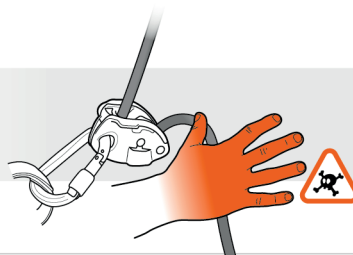
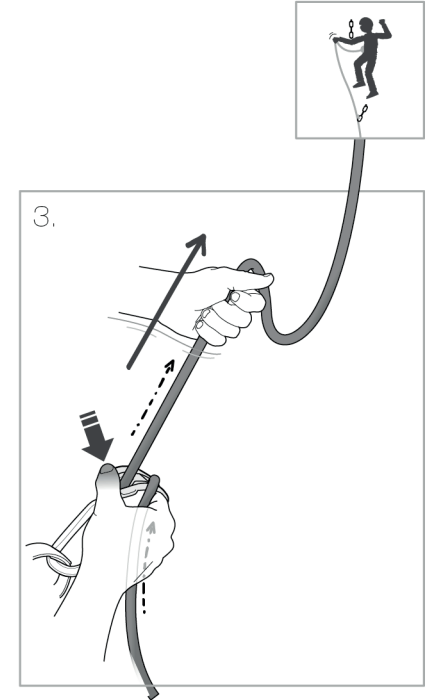
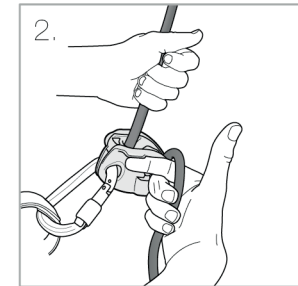
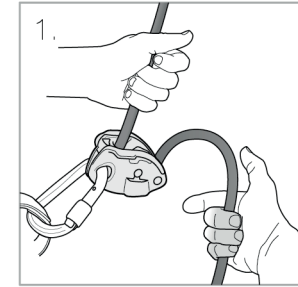

7D. Taking up slack
Reprendre le mou

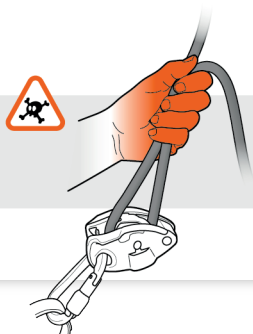
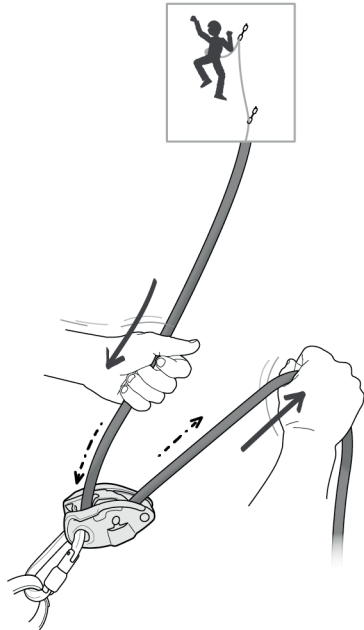

7E. Stopping a fall
Retenir une chute

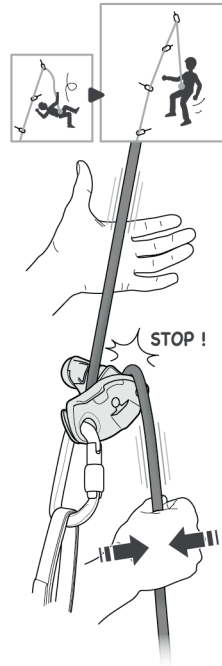

8. Lowering a climber in a top-rope situation
Faire descendre le grimpeur en moulinette

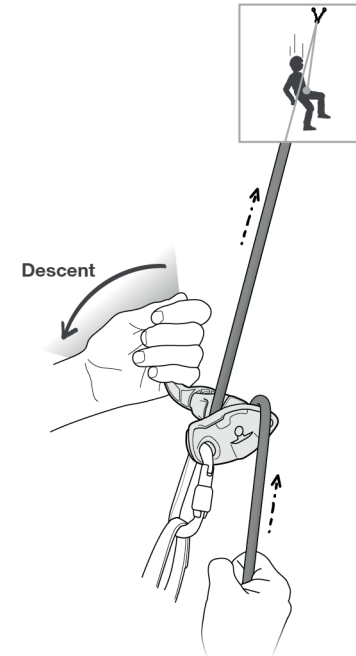

9. Additional information
Informations complémentaires

A. Lifetime / Durée de vie



B. Acceptable T°
T° tolérées



C. Precautions for use / Précautions d'usage



D. Cleaning / Nettoyage



E. Drying / Séchage

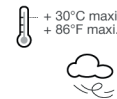

F. Storage - Transport
Stockage - transport



G. Maintenance
Entretien



H. Modifications - Repairs
Modifications - Réparations



I. FAQ - Contact
Questions - Contact



